



**25 Lewis Way**

, Chepstow, NP16 5TA

**£950**



1



1



1



D

Description

\* Completely refurbished to a High Standard \* Coach House Style \* One Double Bedroom with Built-in Wardrobe \* Entrance Hall \* Modern recently fitted Ground Floor Bathroom \* Living Room with Airing Cupboard \* Modern recently fitted Kitchen with Integrated Hob, Single Oven and Grill and Extractor, Washer Machine/Dryer, Fridge Freezer and Slimline Dishwasher \* Electric Heating \* Enclosed Rear Garden \* Two Allocated Parking Spaces \* Excellent commuting links via M48 to Bristol and beyond \* Available from 3rd March 2026 \*

Accommodation

Ground Floor

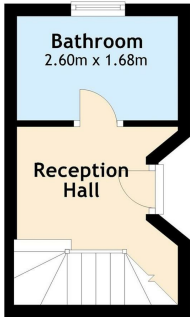

First Floor

